

- SPECIFICATION**
1. Rating : DC 30V 0.5A;
 2. Contact resistance: $\leq 30m\Omega$;
 3. Insulation resistance: $\geq 100M\Omega$ (DC250V);
 4. Withstand voltage: 500VAC ;
 5. Insertion and extraction force: 3-30N;
 6. life test: 5,000 cycles.

TABLE:

COLOR	PART No.
BLACK	EAST-2339L-08DB-PPA
PINK(#199C)	EAST-2339L-08DP-PPA
GREEN(#577C)	EAST-2339L-08DG-PPA

NO.	DESCRIPTION	QTY	MATERIAL	PLATING
9	HOUSING	1	PA9T	Black
8	INSULATOR	1	PA9T	Black
7	SHELL	1	SUS301	NI-Plating
6	TERMINAL-6	1	COOPER ALLOY T-0.20mm	Matte Sn-Plating
5	TERMINAL-5	1	COOPER ALLOY T-0.20mm	Matte Sn-Plating
4	TERMINAL-4	1	COOPER ALLOY T-0.20mm	Matte Sn-Plating
3	TERMINAL-3	1	COOPER ALLOY T-0.25mm	Matte Sn-Plating
2	TERMINAL-2	1	COOPER ALLOY T-0.20mm	Matte Sn-Plating
1	TERMINAL-1	1	COOPER ALLOY T-0.20mm	Matte Sn-Plating

TOLERANCES UNLESS OTHERWISE SPECIFIED:
 X. ± 0.38
 X.X ± 0.25
 X.XXX ± 0.20
 Angle ± 3°

THESE DRAWING AND SPECIFICATION ARE THE PROPERTY OF Shenzhen Dongfangye Electronic Co., Ltd. SHALL NOT BE REPRODUCED.

CUSTOMER COPY

DRAWN: Qinkx
 CHECKED: Chenl
 APPROVED: Chenl

DATE: 2017/09/10

PART NO: EAST-2339L-08DX-PPA

UNIT: mm

SCALE: N/A

SHEET: (Revs)

深圳市东方御业科技有限公司
 WWW.DFYCONN.COM TEL: 0755-27155660

REV.	ECN NO.	MODIFY MATTER	DATE	APPROVED
A		RELEASE TO PRODUCTION		

REV.	ECN NO.	MODIFY MATTER	DATE	APPROVED
A		RELEASE TO PRODUCTION		

FLANGE CORE DIAMETER ($\phi 100$)

AROUND THE OUTER PERIPHERY
IN A TURN,
WEEDING THE COVER TAPE

165°~180° PEELING ANGLE.

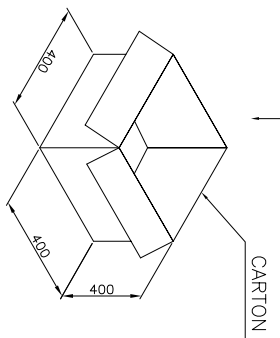
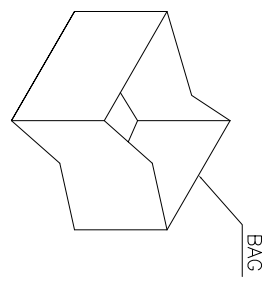
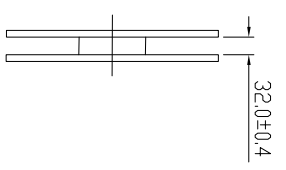
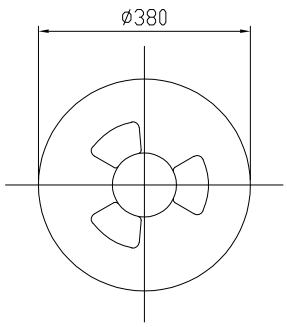
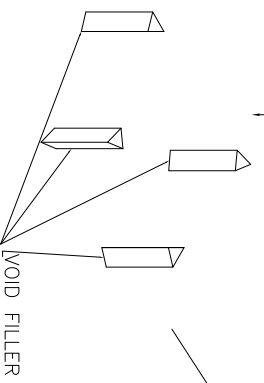
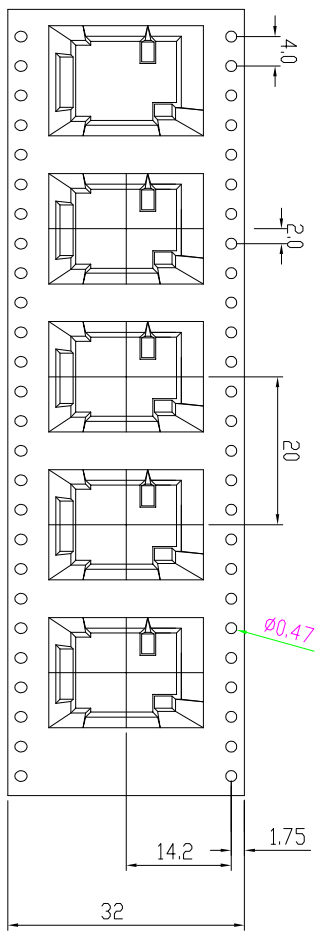
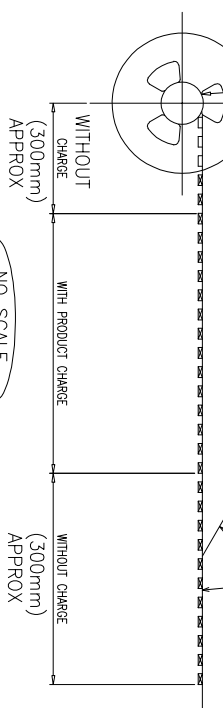

QUANTITY:

500 PCS/REEL

10 REELS/INNER BOX: 5000PCS

- NOTES :
- PACKAGING MATERIAL IN PLASTIC, RUBBER, INK, PIGMENT AND PAINT MUST MEET CONTROLLED SUBSTANCES SPEC PER 230-702.
- * CADMIUM AND CADMIUM COMPOUNDS NOT TO EXCEED: 5 PPM.
- * LEAD, CADMIUM, CHROM VI AND MERCURY NOT TO EXCEED: 100 PPM (COMBINED).
- * CARRIER TAPES, COVER TAPES, REELS AND TAPED COMPONENTS MUST MEET THE REQUIREMENTS DEFINED PER EIA-481-B.
1. MATERIAL :
COVER TAPE : PET
CARRIER TAPE : PS
REEL : PS
SHIPPING BOX: CORRUGATED FIBER
2. DIMENSION :
- REEL : SEE DRAWING
BOX : SEE DRAWING
3. QUANTITY : SEE TABLE
4. WEIGHT : SEE TABLE
5. PEELING RESISTANCE : 10gf~100gf (for 8mm)
6. PEELING SPEED : 300mm/MINUTES

TOLERANCES UNLESS OTHERWISE SPECIFIED:		CUSTOMER COPY		深圳市东方御业科技有限公司 WWW.DFTYCONN.COM TEL: 0755-27155560	
X	± 0.38	DRAWN:	QinKx	2017/09/10	TITLE:
X.X	± 0.25	CHECKED:	Chen	2017/09/10	PART NO:
X.XXX	± 0.20	APPROVED:	Chen	2017/09/10	EST-23391-08DX-PPA
X.XXX	± 3°				SCALE:
Angle					N/A
THESE DRAWING AND SPECIFICATION ARE THE PROPERTY OF Shenzhen Dongyongyue Electronic Co., Ltd. SHALL NOT BE REPRODUCED.		DRAWING NO:		SHEET:	
				REV:	